

Stainless steel push-on fittings

Series RX300



The "RX" fittings series are "oil free" and manufactured according to the ISO norms of reference, and suitable for the following technical and applicative specifications.

Technical sheet

FLUIDS		Compressed air, some liquids (for different fluid please contact our Technical Dept.)
APPLICATIONS		Pneumatic equipments which are applied widely in the range of Industry such as food service industry, chemical industry and medical industry. In general where required to ensure anti-corrosion and acid resistant, or usage at high temperature.
SUGGESTED TUBES FOR THE QUICK SERIES		4x2,5; 6x4; 8x6; 10x8; 12x10; 14x11; 16x13
RECOMMENDED LIMIT VALUES	TEMPERATURE	The working temperatures range is between -20°C and +120°C
	WORKING PRESSURES	The working pressure depends on the type of employed pipe, maximum value 25bar
THREAD TYPE		BSP parallel UNI-ISO 228; BSP tapered UNI-ISO 7; Metric ISO/R 262
MATERIALS	Nut	Stainless steel SUS316
	Body	Stainless steel SUS316
IMPORTANT NOTE		The raw material is non-magnetic, however after cold working, a small amount of austenite could be transformed into martensite, which could be very weakly magnetic.

ART. **RX301**

Taper straight male adaptor



COD.	ØD	F	I	H	🔑1	🔑2	📦	📊
RX30106M5	6/4	M5	4	23,7	12	12	1	14,76
RX3010618	6/4	G1/8	7,5	25	12	12	1	14,00
RX3010614	6/4	G1/4	9,5	27	12	14	1	18,00
RX3010818	8/6	G1/8	7,5	26,2	14	14	1	20,00
RX3010814	8/6	G1/4	9,5	30,5	17	17	1	20,00
RX3011014	10/8	G1/4	10	31,5	17	17	1	32,00

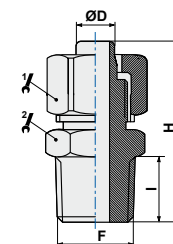

ART. **RX302**

Straight female adaptor



COD.	ØD	F	I	H	🔑1	🔑2	📦	📊
RX3020618	6/4	G1/8	9,5	23	12	14	1	16,00
RX30206146	6/4	G1/4	11,5	25	12	17	1	20,00
RX30208188	8/6	G1/8	9,5	24	14	14	1	20,00
RX30208148	8/6	G1/4	11,5	26	14	17	1	26,00

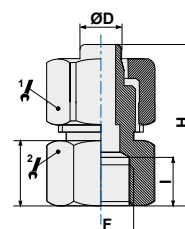

ART. **RX303**

Straight connector



COD.	ØD	L	🔑1	🔑2	📦	📊
RX3030600	6/4	30	12	12	1	22,00
RX3030800	8/6	32	14	14	1	28,00
RX3031000	10/8	37	17	17	1	48,00
RX3031200	12/10	41	19	19	1	61,44

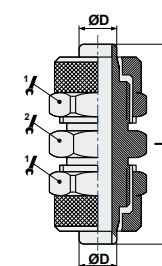

ART. **RX305**

Elbow taper male adaptor



COD.	ØD	F	I	H	L	🔑1	🔑2	📦	📊
RX3050418	4/2,5	G1/8	8,5	17	16	8	9	1	12,00
RX3050618	6/4	G1/8	11	21	21	12	9	1	18,00
RX3050614	6/4	G1/4	11	21	21	12	11	1	24,00
RX3050818	8/6	G1/8	8,5	18	23	14	11	1	24,00
RX3050814	8/6	G1/4	11	22,3	23	14	11	1	26,00
RX3051014	10/8	G1/4	11	23,5	25	17	13	1	38,00
RX3051038	10/8	G3/8	14	25	25	17	13	1	42,00

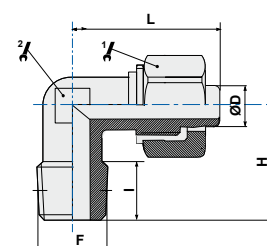

ART. **RX306**

Elbow connector



COD.	ØD	L				
RX3060600	6/4	21	12	9	1	24,00
RX3060800	8/6	22,5	14	11	1	34,00
RX3061000	10/8	25	17	13	1	52,00
RX3061200	12/10	27,5	19	15,5	1	72,14

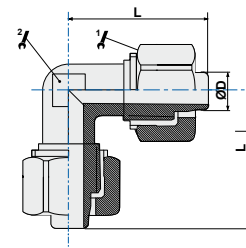

ART. **RX307**

Central T adaptor



COD.	ØD	F	I	H	L				
RX3070618	6/4	G1/8	11,5	22	41,5	12	9	1	30,00
RX3070614	6/4	G1/4	9	22	41,5	12	9	1	36,00
RX3070818	8/6	G1/8	8,5	18	44,5	14	11	1	38,00
RX3070814	8/6	G1/4	12	24	44	14	11	1	38,00
RX3071014	10/8	G1/4	11,5	24	50,5	17	13	1	58,00

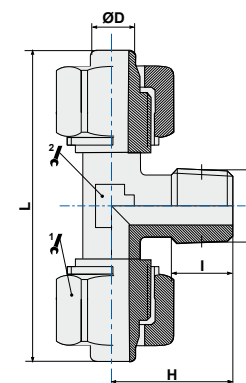

ART. **RX309**

T connector



COD.	ØD	H	L				
RX3090600	6/4	20,5	41	12	9	1	36,00
RX3090800	8/6	23,5	44,5	14	11	1	48,00
RX3091000	10/8	26,5	50,7	17	13	1	74,00
RX3091200	12/10	27,5	55,4	19	13	1	88,00

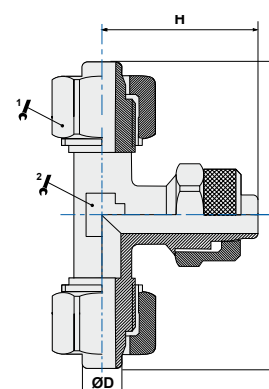

ART. **RX310**

Locking nut



COD.	ØD	F	H			
RX3100600	6/4	M10x1	10	12	1	6,00
RX3100800	8/6	M12x1	10	14	1	6,00
RX3101000	10/8	M14x1	12	17	1	12,00

